

Integral^{plus}



clinical cases Dr. F. Cardarelli

APPLIANCE INDICATED FOR THE FUNCTIONAL TREATMENT OF DENTAL ARCHES WITH MULTIBRACKET

OTHER AMCOP DEVICES

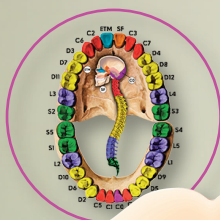

BIO-ACTIVATOR



OPEN



Micerium S.p.A.
Via G. Marconi 83
16036 Avegno (GE)
Italy



Tel. +39 0185 7887 880



sales@micrium.it
gory@micrium.it
www.micrium.com

AMCOP[®]

ortodonzia
M
GRUPPO
MICERIUM

ELASTO DONTIC[®]
therapy

Integral^{plus}

More Aesthetics and Functionality

AMCOP[®]



BIS-GMA FREE
**BPA
FREE**
NO BISPHENOL-A



ELASTO DONTIC[®]
therapy

ortodonzia
M
GRUPPO
MICERIUM

Integral plus

Integral Plus Bio-Activator is a new Elastodontic Appliance of the **Amcop Bio-Activators** range, indicated for the treatment of the arches, during the alignment of the dental elements that compose them, with fixed multibracket Appliances. The aim is to improve, simultaneously with the alignment of the teeth, functional, skeletal, articular and neuro-muscular problems.

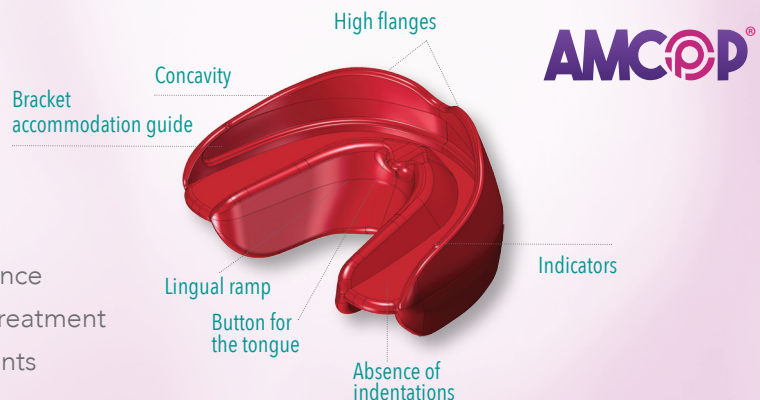

With the **Integral Plus** Appliance it is possible to treat patients with dysfunctional conditions, involving atypical swallowing and oral breathing.

Integral Plus is also indicated for solving skeletal problems concerning distorted and not aligned arches; through a specific orthopedic action provided by the Appliance, in such a way as to

improve the relationship between jaw and mandible accompanied by a relaxation of muscle tone.

Ultimately, with the use of the Integral Plus Appliance, it will be possible to improve the craniofacial skeletal complex, in consideration of the relationships between the bones of the skull and face, with the teeth and their respective bone bases in a global context that

includes the dento-periodontal, skeletal, neuro-muscular system and temporomandibular joints (TMJ). The aim is to obtain a complete reprogramming of the stomatognathic system, through an optimal recovery of form and function. The **Integral Plus** Bio-Activator has been designed with characteristics such that it can be placed simultaneously on dental

arches that have fixed multibracket-type appliances, by means of a particular guide placed in the internal wall of the upper and lower flange, suitable for accommodating the same different types of fixed multibracket equipment.

The Appliance has been designed with the modelling of a specific occlusal guide, in such a way as to be able to adapt it to different types of arches shape unlike the Amcop Bio-Activators, which are characterized by four Appliances with each its own shape.

IP 3

Small Appliance
Red color coded
Cross measurement of 55mm*

IP 4

Medium Appliance
Red color coded
Cross measurement of 60mm*

IP 5

Large Appliance
Red color coded
Cross measurement of 65mm*

* Measure taken from the transverse distance that separates the vestibular cusps of the upper sixths

Integral plus



More Aesthetics and Functionality

AMCOP Integral plus

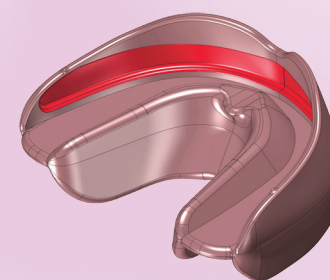
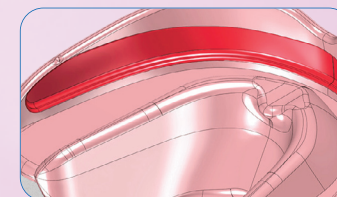

Furthermore, the occlusal guide has been designed with a single occlusal plane corresponding to that of the Integral type, unlike the Amcop Bio-Activators, which are characterized by different types of occlusal planes. The button is always present in the plantar area corresponding to the palatine spot (upper retroincisive palatine area) for a functional education of the tongue. The Appliances were considered in three measures.

FURTHER INDICATIONS

The **Integral Plus** Appliance is also indicated in case of:

- Problems in the temporomandibular joints (TMJ)
- Bruxism (nocturnal grinding)
- Certain tension problems of a neuro-muscular nature
- Muscle-tension headaches in predisposed patients

CONTRAINDICATIONS

The Integral Plus Appliance is contraindicated in case of:

- Dental elements with marked periodontal mobility
- Overt gingivitis

